

# TABELA DE MOBILIÁRIOS

MOBILIÁRIO EXISTENTE

MOBILIÁRIO NOVO



CADEIRA PLYWOOD EAMES  
2un.



CADEIRA EAMES  
1un.



CADEIRA FORMIGA ACRÍLICO  
2un.



CADEIRA GIRATÓRIA  
18un.

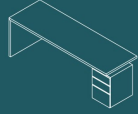

MESA RECEPCIONISTA  
1un.



MESA BIOMETRIA  
1un.

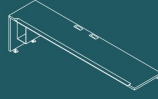

MESA DE TRABALHO 2 PESSOAS  
8un.



MESA LATERAL  
1un.



ARMÁRIO BIOMETRIA  
1un.



GAVETEIRO SECRETÁRIA  
1un.



ARMÁRIO SECRETÁRIA  
1un.



GAVETEIRO PEQUENO  
8un.



ARMÁRIO MÓDULO 1  
2un.

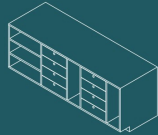

ARMÁRIO MÓDULO 2  
2un.

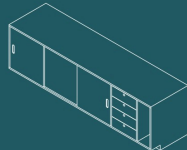

ARMÁRIO MÓDULO 3  
2un.



ARMÁRIO MÓDULO 4  
1un.

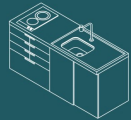

BALCÃO DA COPA COM PIA  
1un.



ARMÁRIO ALTO COPA  
1un.



BANCADA COM ARMÁRIO  
1un.

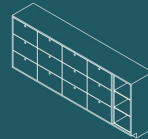

ARQUIVO  
1un.



MICROCOMPUTADOR  
18un.



MONITOR 18,5"  
22un.



MONITOR 19,5"  
2un.



MONITOR/TV 42"  
4un.



IMPRESSORA  
2un.



IMPRESSORA  
1un.



MICROONDAS  
1un.



REFRIGERADOR  
1un.

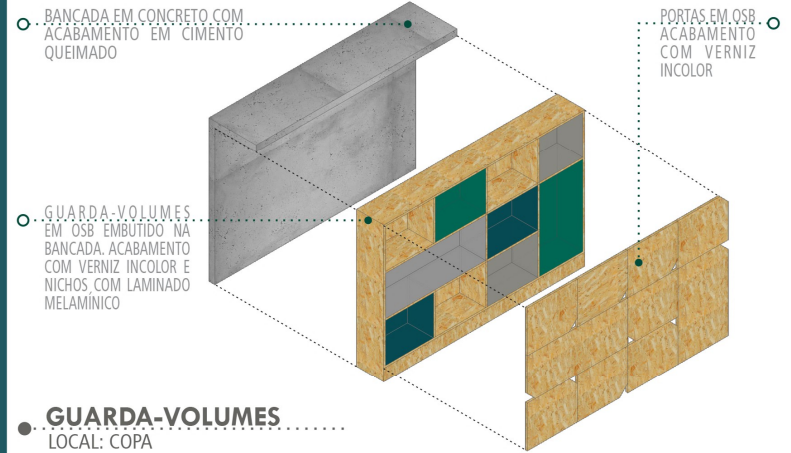

## GUARDA-VOLUMES LOCAL: CÓPA

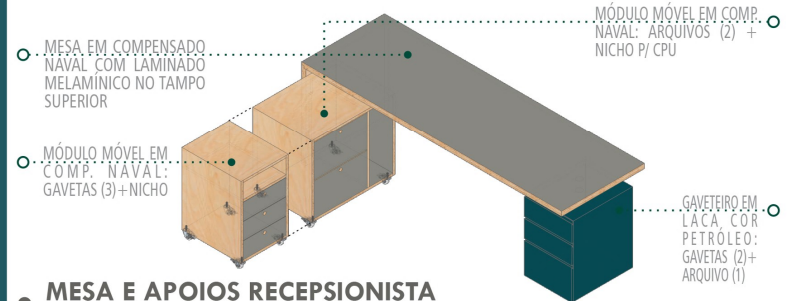

## MESA E APOIOS RECEPCIONISTA LOCAL: RECEPÇÃO

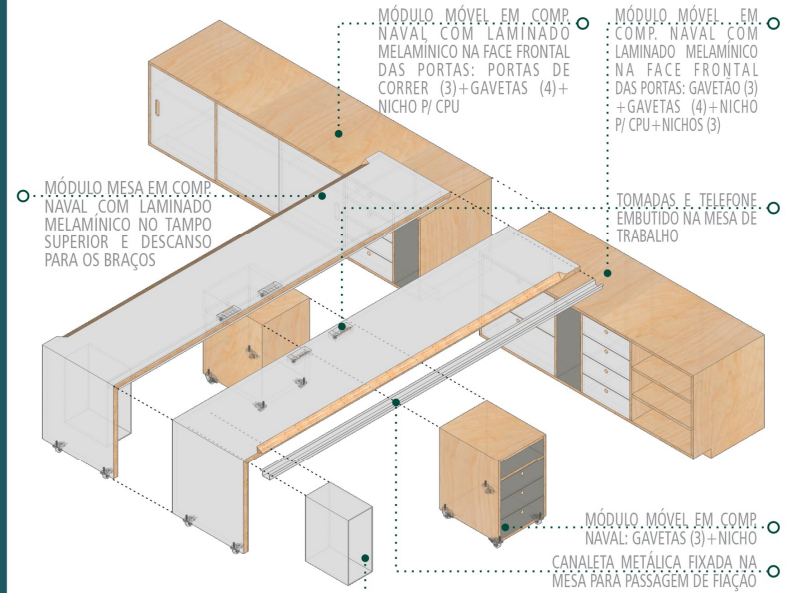

## MESAS E APOIOS LOCAL: ESPAÇOS DE TRABALHO

TABELA DE QUANTITATIVO: MOBILIÁRIO NOVO E EXISTENTE  
DETALHAMENTO MOBILIÁRIOS

ESPAÇO PARA ETIQUETA DE  
PROTOCOLO DE INSCRIÇÃO

PRANCHA:

6/8